

L.E.N.S.

Monthly publication of the
Lake Erie N Scale Society



N-TRAK
N SCALE MODULAR RAILROADING

November, 2004

Welcome!

LENS is a group of people with a common interest in modeling N scale railroads using the "NTRAK" modular concept.

Any time we meet and/or display our work and promote this hobby, we would love to have you join us.

This means that ALL of us have chances to participate in the hobby by helping with any or all of the following:

Setting up/tearing down
Running trains
Sharing your knowledge
Learning something new
Answering questions
Hosting a meeting

Notice that NONE of the above requires a module. We need your help... so bring yourself, your enthusiasm, your interest and your trains.

Thanks in advance for helping! Hopefully, we will continue to see you at the meetings and display events.

Come and join in the fun!

www.geocities.com/lensohio/

The Lake Erie N Scale Society newsletter is published monthly for the sole use of its members by a crew of volunteers.

Opinions published here are solely those of the editor and/or the members of the Lake Erie N Scale Society.

This publication is intended to be a monthly newsletter describing the business, events and the common interest in N scale model railroading enjoyed by the members of the Lake Erie N Scale Society.

For information or questions regarding our Society, you may contact Dennis Lloyd at 440-352-7081 - or - (dlloyd@apk.net)

Meetings normally start at 8:00 p.m., the fourth Friday of each month.

Lake Erie N Scale Society

November, 2004



One of the new types of modules that were seen this summer at the N Scale convention in Chantilly, VA, were the Ttrak modules. These are smaller modules that feature two tracks on an approximate one foot by one foot frame, designed to sit on a table top or shelf.

The interesting thing demonstrated about Ttrak, was they are usable in every scale. Not only were several of them connected together to form an N scale layout, but there were frames on display showing how they could be used in HO, G, Z, O, S, etc.

This format was made popular in Japan. They find the modules easier to store and display in a limited amount of space. Set up is simply connecting the modules together, on top of tables. There are no legs to worry about. Modules are being built with straight track (left to right), curves, etc., providing a way to build very elaborate displays.



Last Month's Meeting

We met at Richard F.'s home to begin planning the set up schedule for this coming "season". In the immediate future, we will be doing a set up at the Burton Library and the Lake County FarmPark.



Richard was not only brave enough to invite this crew in, but invited the us to run trains on his home layout. The "division" that we used, is "stage one" of what is promised to be a large, basement filling layout.



This Month's Meeting



The pictures above should be enough for you “old timers” in the group. However, for the newer members...

We will set up a display in the library on the square in Burton, OH. The tradition is that we set up the layout in the

library on Friday, followed by eating *pie* at Belle's Restaurant on the square. This display is usually done the same time as the book sale which hopefully helps us to draw a crowd..

Setup will be on Friday (11/26) from 1:00 p.m. to 1:15 p.m., followed by pie from 1:16 p.m. to 5:00 p.m. (or something like that). Running will be on Saturday (9:00 a.m. to 5:00 p.m.) & Sunday (1:00 p.m. to 5:00 p.m.), with tear down to follow.

This venue is usually a relaxed one where we have a chance to socialize with each other and run lots of trains.

Learning From Prototype

How many engines do I need?

The number of engines needed for a given consist, varies based on a number of conditions. Let's define some terms and discuss some typical conditions that will affect a train.

Tractive Effort is the pull a locomotive exerts at the drawbar, usually measured in pounds. This is a measure of the maximum force the locomotive can deliver to move a train forward. Modern freight diesels operate in the range of 100,000 pounds of tractive effort.

Adhesion is tractive effort as a percentage of the locomotive's weight. This measures how the locomotive puts its muscle to work. Higher adhesion, means the locomotive puts its power on the ground better.

A freight locomotive should have high adhesion and high tractive effort, in order to be good at starting a heavy train. A passenger engine will be built for speed, and therefore is lighter. It may have the same HP rating, but lower tractive effort and adhesion. You'd probably rather have an SD40-2 than an F40PH on a container train, even though they're both 3000 HP.

The GP50, for example, was rated at 3600HP, but it didn't weigh much. EMD got higher tractive effort out of it using the "Super Series" wheelslip control system, which improved adhesion. Super Series failure meant tractive

(Continued on page 7)

(Continued from page 6)

effort dropped substantially.

"Cars per engine" is as much a function of the road as the engine. Most timetables have *equated tonnage* ratings for the road's various locomotives, to quantify how many tons of train a single locomotive of a given class is rated for on the region's curvature and grades. If your power is rated for 1800 tons per unit, & you have 3600 tons of train, you need at least 2 engines. Developing these ratings was the main purpose of Dynamometer cars.

Another thing to remember is the **ruling grades** of the division and what the tonnage is of the train. Recall a ruling grade is not always going up a steep mountain, it may just be a 1% grade on a curve, which would have a factor on how many locomotives are needed to pull the tonnage up and around that curve.

Most divisions are big enough that they include *both* sides of the hill. Besides, east/west tonnages add complexity, and railroads hate complexity - it is easier to have one rating for the whole district / region. Furthermore, if you need horsepower to get up the hill, you also want dynamic braking horsepower to get *down* the hill, so you still need those engines.

These are the basics. Hopefully they will give you a rough idea of what goes into the decision regarding "how many?".

Our "Annual Swap Meet", is now available at every meeting!

If you have surplus engines, buildings, rolling stock, modules, etc., bring them to any of the meetings to offer great deals to your fellow members.



SCALE TRAINS OF THE GIL STO

**Saturday, November 27, 2004 (Thanksgiving)
8:45am Wadsworth Ohio Eagle Banquet**

DIRECTIONS: Exit off Interstate 76 onto State Rte #57, head South 10 miles to Blinker (State Road) Turn Right (South) 2 miles to Auction

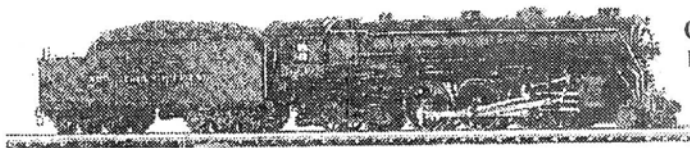

OUTSTANDING
brass, 4-12-2 UP 900
fus Hudson, brass,
4-8-4 J-#611, Sun
4-8-4 import brass
detailed brass ca

LIMA, Weaver, Westbrook, All Nation, Kit Bashed Cast, Walthers, Main Line rivarossi,

OTHER ITEMS: Lionel Scale Pre-War #714 Boxcar, #715 Tank, #716 Hopper, #717 Caboose, IVES #3252 Engine. Some HO Locomotives/Cars.

RAILRODIANA: Original FM Engineers Seat, Station Master's Cap, GP-9 Engine Marker Lite, Caboose Msrker Lite.

BOOKS-PAPER GOODS: Many books, magazines--Some dating back to the 30's (M

ACCESSORIES: Many Scratch Blt. Buildings, Plasticville, Boxed Lots w/Engine Parts

TOYS: Over 200 Collectible Die-Cast Toys--Mostly From Layout--Older, Uncommon Co Lledo, Renwal, Solido, Tekno (Denmark), Britains, Rubber/Cast/Lead Toy Soldiers & Pe

AUCTIONEERS NOTE: This very large auction has something for everyone! The updated & improved it. The trains are somewhat dusty but for the most part are in great s day, there will be two auction circles. So bring a friend in case you want to bid on someth

TERMS: Cash, good check w/ID (no out of state checks)--Must have Travelers Checks, M welcome--Must be bid from purchased catalog. Line item catalog w/ grading and commen



JIM EASTWOOD
OUR TENTH YEAR OF AUCTIONING

Contact Jim Eastwood, P.O. Box 27, Sunbury, Ohio
or (440) 256-8141

IN AUCTION DVICEK ESTATE!



ing Weekend) Time: 9:30am / Preview:
Hall (25 Miles S.E. of Cleveland, Ohio)

on #57 1 mile to traffic light. (Seville Road) Turn Left (East) .8
t Eagles Banquet Hall (99:3 State Road)

SELECTION: Over 65 2-Rail scale locomotives (some in orig. boxes!) 2-8-8-2 N&W 6B,
0, brass, 2-10-4 PRR J., brass, 2-8-8-4 Yellowstone, brass, 2-10-2 SF, brass, 4-6-4 NYC Drey-
(All Scratch Blt.), Max Gray 2-6-6-6 Allegheny, Max Gray 2-10-0 Decapod, brass, Sunset
set 4-4-6-4 PRR Q-2, brass, U.S. Hobbies 2-8-2 NYC H-10-B Mikado, brass, U.S. Hobbies
s, (2) "700 E" 4-6-4 Lionel Hudsons (Modified for 2-Rail) ROLLING STOCK: A number of
rs, also Atlas, KRISS (KMT), POLA Kit Bit. U.S. Hobbies, converted Lionel cars, KUSAN,
Thomas, La Belle, Pecos River

aboose, Lionel STD Cars #516 Hopper, #214 Reefer, #514 Boxcar, #620 Floodlight Car, #517

e Builders Plate, Engine Steam Whistle, Caboose Oil Lamp (England), Hand Torch, R>R>

odel Craftsman, Miniature Railroad(ing), Engine Diagrams/Blue prints.

s, Motor Parts, Brass/Lead Items.

rgi Cars, Barclay, Elgin, Saki, Vilmer, Matchbox, Banner, Revell, Ertl, Dinky, Pyro, Liebherr,
ople

late Mr. Stovicek started building his scale train layout over 35 years ago and continually
hapse because they were run & maintained regularly. Due to the amount we are selling in one
ing in each circle!

Money Orders or certified Checks. VISA, MC and DISCOVER also accepted. Absentee bids
ts is \$7.00. Catalogs will be mailed last week of October.

OD AUCTIONS

NG TRAIN AND TOY COLLECTIONS

43074 (740) 965-4778 Fax (740) 965-5410. Member TCA, LCCA

Bob Frieden (Family Friend)



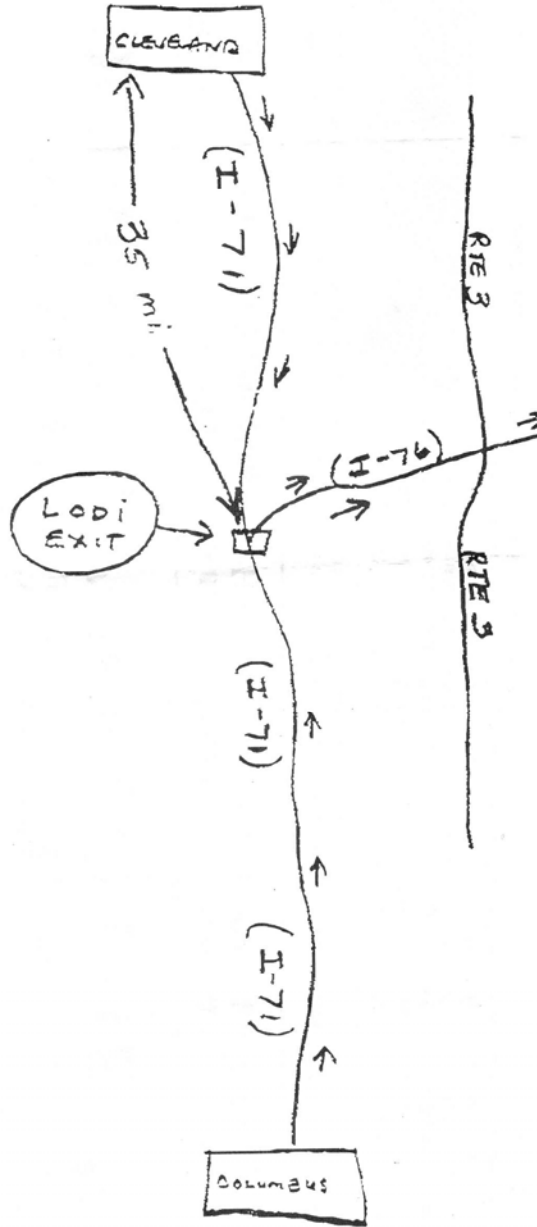

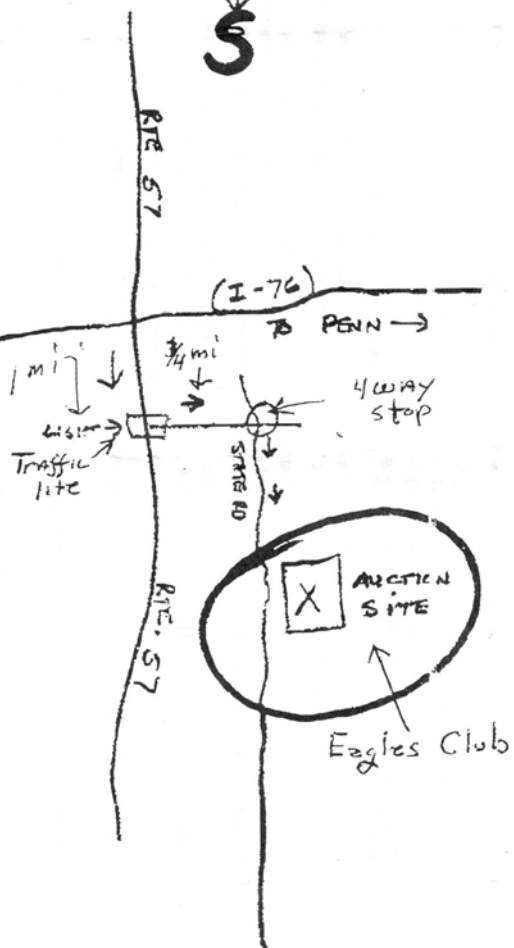
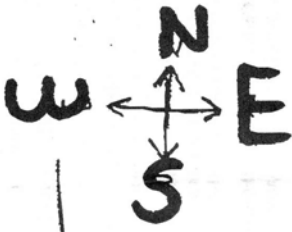

Next Month's Meeting

We have again been invited to set up a display at the lake County FarmPark. This year however, based on a discussion by the membership, we have limited the amount of days that we would provide. In the past few years, we have been asked to cover more and more of the available days. The thinking was, that the burden at the "holiday" time of year was to great. So we "put our foot down" (a dangerous thing to do at a farm), and agreed to 6 days.



Note the starting time is 5 p.m. Typically, we have two shifts—those persons that are able to be there at 5 p.m. and put in (1 or more) hours, and those folks who arrive later and close the doors.

Remember, that as a member of the LENS group, you may enter via the rear service drive (west of the main entrance) and go through the offices to gain access to the display room.

This venue has always been a "tough" one to control as the room is small and the crowds come in "herds" (as other events let out). As such, we need to have as many members present to do crowd control. Try to set aside as much time as possible to attend. We can use a minimum of 1 person inside the layout and 2 people outside. With the radio controllers, it is possible to run trains and watch the crowds.

Layout Planner

Venue	<i>Burton Library</i>	<i>Dates</i>	<i>Event times</i>
Set up	Friday	11/26/04	1:00 p.m.
Oper.	Saturday	11/27/04	9 a.m. to 5 p.m.
	Sunday	11/28/04	1 p.m. to 5 p.m.

Venue	<i>FarmPark</i>	<i>Dates</i>	<i>Event times</i>
Set up	Saturday	12/18/04	1:00 p.m.
Oper.	Saturday	12/18/04	5 p.m. to 9 p.m.
	Sunday	12/19/04	5 p.m. to 9 p.m.
	Monday	12/20/04	5 p.m. to 9 p.m.
	Tuesday	12/21/04	5 p.m. to 9 p.m.
	Wednesday	12/22/04	5 p.m. to 9 p.m.
	Thursday	12/23/04	5 p.m. to 9 p.m.

Venue	<i>Railfest</i>	<i>Dates</i>	<i>Event times</i>
Set up	Friday		
Oper.	Saturday		
	Sunday		

[“web.page”](#)

With cooler weather just around the corner, I thought it would be a good time to look at a newer manufacturer who could provide materials for those indoor projects we will soon be involved with. The company is BLMA (which I think stands for “Best Little Models Available.) <http://www.geocities.com/nscaleblma/index.html>. It is owned and operated by Craig Martyn, a 19 year old college student, who is trying to provide detail parts that he needed but could not find.



He currently manufactures Square Antenna Dome, \$2.00; Modern EMD Cut Levers- Etched metal (1 pair), \$3.00; Stanchion Mounted MU Cable Holder, \$1.75; Porch Mounted Ditch Lights, \$2.00; Modern EMD Cab Sunshades- Etched Metal, \$3.25; Spartan Style Cab Doors, \$3.25; Grab Irons- Standard Size, \$1.75; SD40-2 Style Anticlimber, \$2.00; Round Style Pilot Mounted Ditch Lights, \$2.00; Rear Fan Grab Iron - Round Style, \$1.75; Rear Fan Grab Iron - "V" Style, \$1.75; EMD Style Truck Mounted Spare Knuckle, \$1.75; Tall Ditch Lights w/ MU Receptacle, \$2.00; Short Porch Mounted Ditch Lights, \$2.00; SW1500 Nose Conversion, \$2.50; 46" Grab Irons, \$1.75; EMD Dynamic Brake Vent, \$1.75; Tall Porch Mounted Ditch Lights, \$2.00; All Weather Window, \$2.00; 10.5' Track Side Tank (2 ea),

\$2.00; 15" Grab Irons with Drop (20 ea), \$5.75; Small Round Hopper Car Top Hatches, \$2.00; Bulk Pack Of #13 (5 pair), \$10.00; Derail Device (Code 40+), \$2.00; Small Cab Roof Mounted GPS Antenna Dome (UP), \$1.75; Modern Rear View Mirrors (Reg. & Small), \$3.25; Modern EMD (SD70+) Fan (enough for 1 loco), \$7.00; Bulk Pack of #59 Drop Grab Irons, \$15.50; #80 Drill Bits, \$8.25; Trainline Air Hoses (injection molded), \$4.75.

Pictured below are the new drop grab irons:

BLMA #59 & 67
15" Grab Irons w/Drop
(MACHINE BENT!)

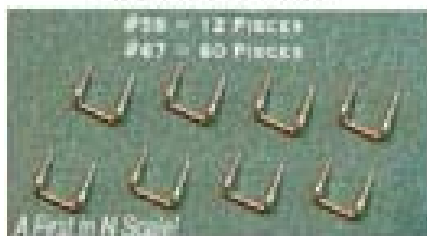

Future products include Air Conditioner - Vapor, Air Conditioner - Prime, Removed Headlight Covers (5 Styles!), Beacon Stands, Angled Cab Sunshades, Frame Mounted Bell (etched metal), 48" Fan Grills/Blades w/o Center Ring, 48" Fan Grills/Blades w/ Center Ring, Modern Grade Crossing - Rubber, Modern Grade Crossing Expander - Rubber, Modern Grade Crossing - Concrete, Modern Grade Crossing Expander - Concrete.

Walthers is the exclusive distributor of these products.

Visit our web site at www.geocities.com/lensohio/

“F.R.E.D.”



Adelaide, SA, Australia

See you at the next station!